

1. Turn off all electrical and air supplies. Relieve pressure to gun, and turn off valves on top of gun. Then remove cartridge by unscrewing the large knurled knob underneath.
2. Unscrew nut from back of cartridge.
3. Remove all internal parts:
 - a. Cartridge Nut
 - b. Valving Rod
 - c. Spring Washer (qty 20)
 - d. Lube reservoir
 - e. Wiper
4. Using a 1/4-20 tap, screw into the Teflon Mixing Chamber. Insert a 3/16" diameter rod (2" long or more) from the front side of Cartridge Housing (small hole), and push the mixing chamber out of the housing. Alternative: After screwing tap into Teflon Mixing Chamber, apply heat to outside of cartridge housing, and pull Mixing Chamber out with a tap handle.
5. Clean the Cartridge Nut, Valving Rod, Lube Reservoir, Housing, and Spring Washers.
6. If possible, polish the Valving Rod to a high luster. This will greatly increase the life of the cartridge.
7. Install new Teflon Mixing Chamber into Cartridge Housing:
 - a. Line up pin in Cartridge Housing with groove in Mixing Chamber.
 - b. Note drawing for position of Mixing Chamber on insertion; the smaller end of the Mixing Chamber (farthest from the Orifices) will go in first.
 - c. Press Mixing Chamber into Cartridge Housing, until the Orifices in Mixing Chamber are visible through the ports in the Cartridge Housing.
8. Replace black O-Ring in Cartridge Nut.
9. Lubricate Valving Rod with E-Z Lube and insert through Cartridge Nut.
10. Stack Spring Washers, Lube Reservoir, and Wiper onto Valving Rod as shown in drawing.

NOTE: The Spring Washers are concave and **MUST** be stacked alternately, per diagram:

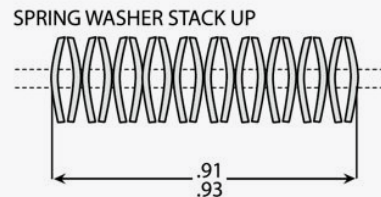

11. Using the white E-Z Lube grease supplied in the Rebuild Kit, fill the inside of Cartridge Nut, insides of the Spring Washers, and the Lube Reservoir. Install the Wiper with bevel toward Lube Reservoir.
12. Coat end of Valving Rod and threads of Cartridge Nut with E-Z Lube. Also fill Cartridge Housing about 25% full of E-Z Lube.



INSTRUCTIONS FOR REBUILDING E-Z FLOW CARTRIDGES

13. Slide the assembled Valving Rod stack into Cartridge Housing. Push Valving Rod into the Teflon Mixing Chamber and hand tighten the Cartridge Nut. There should be about a 1/16" gap between the housing and the nut.
14. Push Valving Rod through the Teflon Mixing Chamber. Some excess E-Z Lube will ooze out through hole at end. Tighten Cartridge Nut with 3/4" wrench. If Nut will not tighten all the way, back off the Nut to remove pressure, and pull Valving Rod out about 1 inch. (Excess E-Z Lube will shoot out the end of the cartridge.) Then repeat this step.
15. Align end of Valving Rod with boss on Cartridge (see drawing).
16. Install Cartridge Assy onto gun with new Teflon O-Rings and some E-Z Lube.

[See Page 3 for Cartridge Assembly Diagram and Parts List](#) >

For technical assistance with this, or any other E-Z Flow products, please contact us:

CARTRIDGE ASSEMBLY DIAGRAM AND PARTS LIST

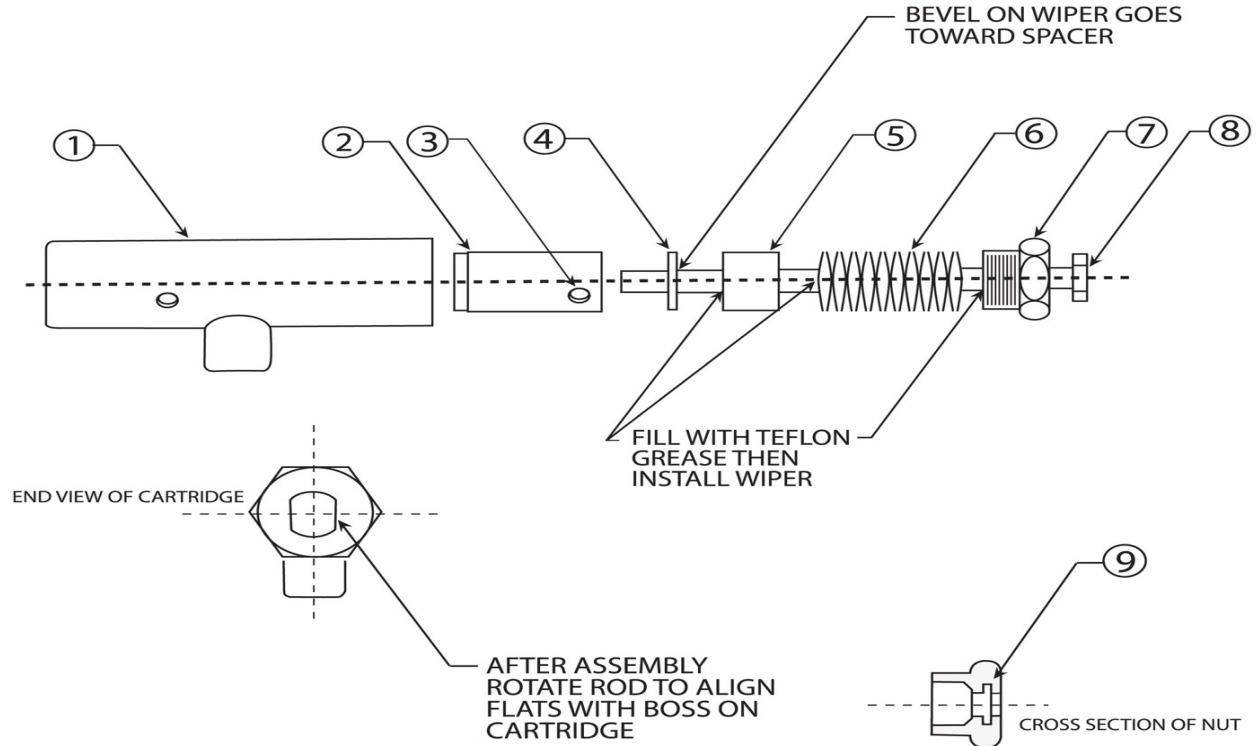

Item numbers shown (refer to drawing)

ITEM	PART #	QTY	DESCRIPTION
1	1003	1	Cartridge Housing
2*	1001	1	Teflon Mixing Chamber (includes Item 3 – 1002 Orifice)
4*	1008	1	Wiper
5	1005	1	Lube Reservoir
6*	1502	20	Spring Washer
7	1006	1	Cartridge Nut
8	1004	1	Valving Rod
9*	2105	1	Cartridge Nut O-Ring

*Included in Cartridge Rebuild Kit

E-Z Lube Teflon Grease is available in 6cc syringes for \$15.00 each, or larger 15cc syringes at \$22.00 each.